

# 1:12 Electric 4WD Climbing car

14+



Caution: This model is not a toy, It is designed for user over 14 years of age.

Please use this instruction and the R/C system instruction at the same time.

The instruction is suitable for a type of model whose number is 12427-B.

Safety and caution .....	1-2
Troubleshooting • Product introduction .....	2-3
Instruction of common tools and installation the electronic part...	4-5
Practice and maintenance.....	6-7
Assemble exploded view .....	8-19
Fittings view .....	20-27

## Safety and Cautions

- \*Never run the model on public roads or streets, as it could endanger traffic.
- \*Never run the model in crowded areas, near or toward people or animals, to prevent property damage and/or personal injury.
- \*Never run the model near rivers, ponds or lakes as to prevent R/C car from dropping into the water.
- \*Make sure that no one else is using the same frequency as yours in your running area. Using the same frequency at the same time, whether it is driving, flying or sailing, can cause loss of control with R/C model, resulting in serious accidents.
- \*To avoid a runaway R/C model or loss of control, always follow the procedure below:
  1. Fully extend transmitter antenna.
  2. Switch on transmitter.
  3. Switch on R/C model.
- \*Follow reverse procedure to shut down.
- \*Never touch or hinder rotating tire.
- \*Never run R/C model in the rain or let run over puddles, as water may cause trouble with R/C model.
- \*Motor and battery get very hot after running. Take care when handle them.
- \*Retract transmitter antenna when not in use.
- \*Remove the batteries from model and transmitter when they are not in use.

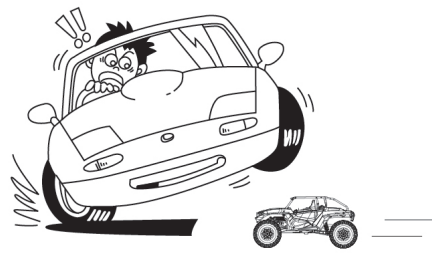

## Cautions when handling batteries

- \*Do not dismantle the battery or charger and do not cut any battery cables. This may cause short-circuit and/or damage to the product.
- \*Change battery with compatible charger following proper procedure that is called out in the instructions. Do not modify charger or charge battery in improper way.
- \*Do not recharge battery that is still warm from use as it may damage the battery. Allow the battery to cool off prior to recharging.
- \*Make sure to disconnect charger cables from R/C model and electric outlet when not in use.
- \*Remove transmitter battery when not using it for a long time as it may leak and damage transmitter when left for a long period.
- \*Never incinerate used batteries, as they can explode causing serious accidents.



## Safety precautions

Do not operate the model on public roads, in crowded places or near infants, it may cause accidents or injury.

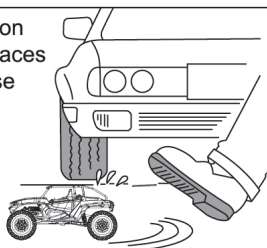

As the product includes small and sharp parts, assemble and store this product only in places out of the reach of children.



As the front end of the antenna may be dangerous, do not aim it toward faces.



During the car running and after, the motor will be hot. Please do not touch it until it has had time to cool down.



Don't use the same frequency with others at the same time. Or the car will lose control or even lead to serious accidents.

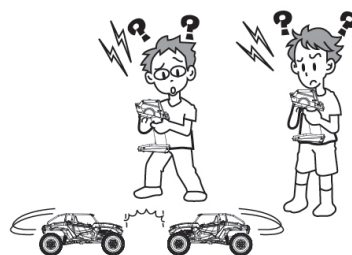

## Troubleshooting

Description	Cause	Solution
The car does not operate at all.	Transmitter or receiver is off.	Turn on both transmitter and receiver.
	Batteries are not placed properly in the transmitter.	Place batteries in the transmitter properly.
	The drive battery is not charged enough.	Charge the drive battery.
The car does not follow your operation and control distance not enough long.	Someone else is using the same radio frequency as you are using.	Change your radio frequency to the one no one else is using, wait until the driver using the same radio frequency finishes driving, or drive your car at a different place.
	There is not enough power in the transmitter or receiver batteries.	Replace the transmitter batteries with new ones and charge the drive battery.
	Not tighten antenna on the transmitter/not fully extend antenna.	Make sure insert antenna into the transmitter and fully extend antenna.



## CAUTION

- \* Please observe the operation manual or packing explanation to install and use, and some parts should be installed by adults.
- \* The product contains small part, it may cause swallow or choke.
- \* Never run an R/C model in the seep or rain, moisture areas, or it may cause the parts malfunction.
- \* Please throw the wrapper in time to avoid danger for the children.
- \* Regularly examine for damage to the charge, wire, plug, bodyshell or other parts. In the event of any damage, it must not be used until the damage has been repaired.
- \* The charge, battery box and battery must insert with the appointed power source of product symbol same.
- \* This product must only be used with the original collocation charger.
- \* The product is contains the functional outshoots are may be dangerous to the children.



- \* Apart the charger and toy before clean.
- \* As the front end of the antenna may be dangerous,do not aim it toward anyone's body,face or eyes.
- \* Batteries are to be inserted with the correct polarity.
- \* Use the "AA" non-rechargeable or "AA" rechargeable batteries.
- \* Non-rechargeable batteries are not to be recharged.
- \* Rechargeable batteries should only be charged under adult supervision.
- \* Rechargeable batteries must be removed from model before charger.
- \* Different types of batteries or old and new batteries are not to be mixed.
- \* Exhausted batteries are to be remove in time.
- \* The supply terminals are not to be short-circuited.
- \* Never short circuit the batteries. throw it in a fire or attempt to open their outer casings.
- \* Please remove the batteries when not in use.
- \* Please retain these instructions for future reference.

## Product Introduction

- ★Type: 1:12 Electric 4WD Climbing car
- ★Product size:350\*235\*165mm
- ★Wheelbase:253mm
- ★The minimum distance of front and rear wheel: 160mm
- ★Ground clearance:40mm
- ★Transmission ratio:1:9.12
- ★Tire diameter: 93MM;wheel width:32mm
- ★ESC receiving server:three in one circuit
- ★Motor:540 brush motor
- ★Remote control: 2.4G Remote control
- ★Remote control distance:≥100M
- ★Remote control battery: 4 AA batteries (not included)
- ★Battery:Lithium battery 7.4V 1500 mAh
- ★Charging time:3 hours
- ★Use time: 10 minutes
- ★Server:25 g servos
- ★Car shell: antiknock PVC printing car shell, beautiful Crashworthiness
- ★Driving speed: 50km/h.

## Proportional R/C Using Instruction

- ① Turn left the steering wheel, the car will turn left. Turing left angle can be adjusted by the degree of wheel twisting.

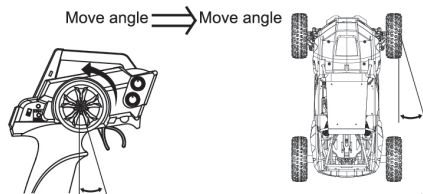

- ② Turn right the steering wheel, the car will turn right. Turing right angle can be adjusted by the degree of wheel twisting.

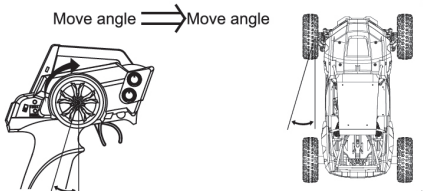

- ③ Pull the throttle trigger backward, the car will forward. Adjusting the angle of throttle trigger can adjust forward speed of the car. During the car forward, quickly push the trigger forward to stop it.

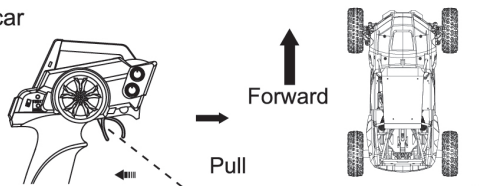

- ④ Loosen the trigger to make it return the neutral position when brake. Push the throttle trigger forward, the car will backward. Adjusting forward angle of throttle trigger adjust backward speed of the car.

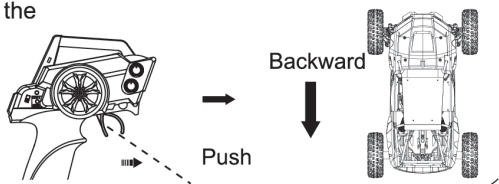

## Introduce the common tools and assemble the electron parts

### Tools needed for assembly

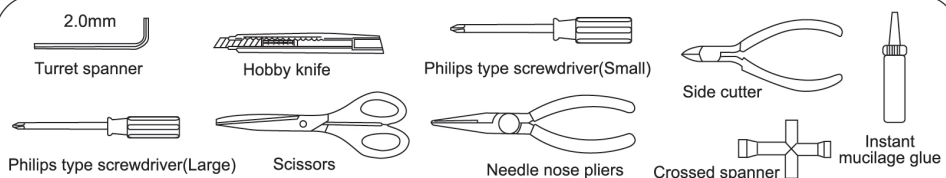

## Charge caution

### CHARGING BATTERY

- 1) Please firstly check and confirm input voltage of the charge is consistent with local voltage, output voltage of the charge is consistent with battery voltage.
- 2) Battery must be used up before you charge, Charging time is not more than 3 hours.
- 3) Be careful to make sure there is adult to control when charging.

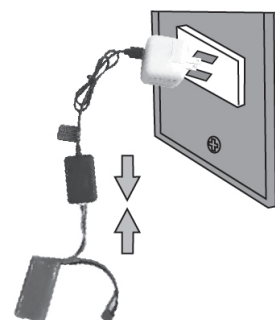

## Assemble the electron parts

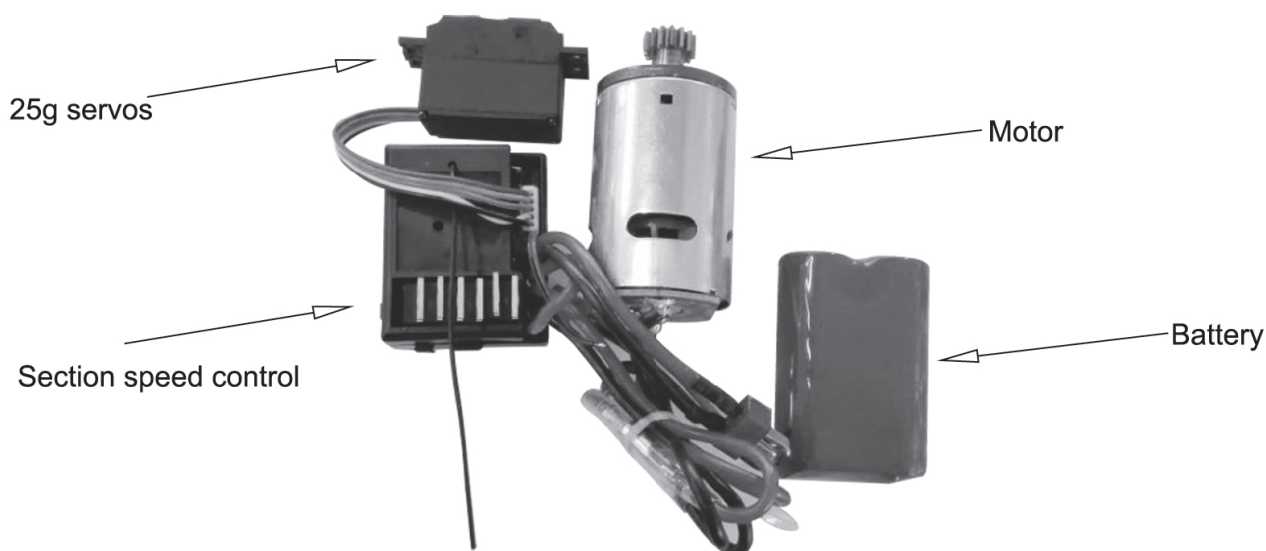

### HOW TO CODE

1. Turn on the remote control power switch, the power indicator on the remote control flashes red, and then turn on the model car power switch, the light on the receiver flashes.
2. Turn the remote control to turn the control wheel or slightly crank the trigger. At this time, the remote power indicator light is steady red and the indicator light on the receiver is steady light, indicating that the code is successful.

## PRACTICE AND MAINTENANCE

### Operating program

1. Turn on the power switch ① on the remote and make sure the power indicator ② flashes red, then turn on the model car's power switch.
2. The model car on the shelf, gently hook remote control on the trigger ③ to observe whether the car can move forward and backward.
3. Turn the remote control steering wheel ④ to the left or right and make sure that the front wheel's steering follows the command.
4. The model car on the ground, and standing behind the model car, gently hook the remote control throttle trigger ③, if the model car does not go straight, rotate the remote control front wheel trim ⑤, the model car to the right side, the front wheel Turn the trim to the left, the model car leans to the left, and the front wheel trims to the right to rotate until the model car can go straight.
5. Throttle speed adjustment ⑥ can adjust the model car speed, rotate to the right, hook the trigger model car speed becomes faster, turn left, hook the trigger model car speed becomes slower.
6. OK, ready to run.

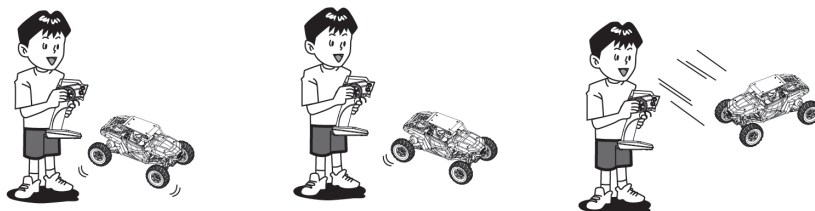
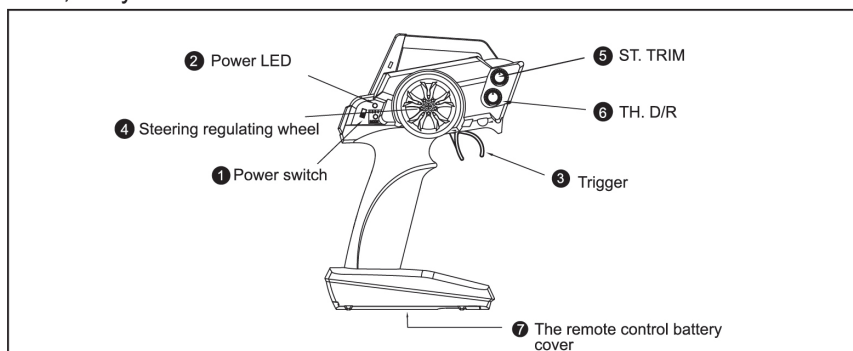

## Practice

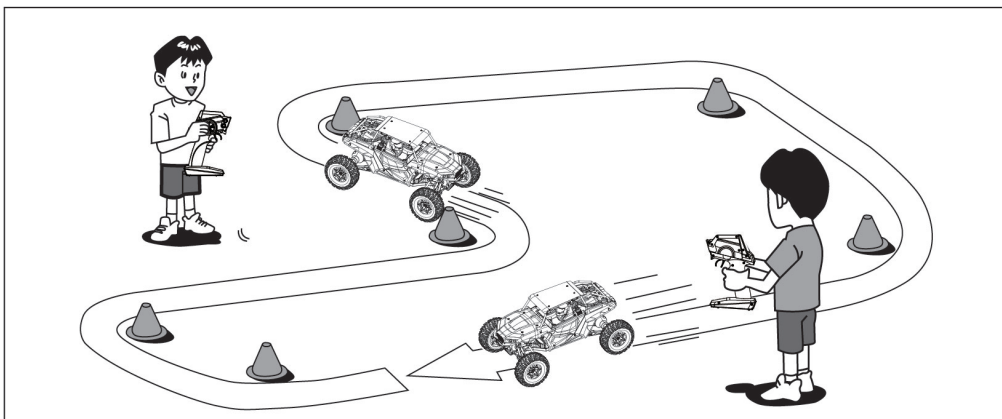

Let's practice! Make R/C car circuit at a wide and safe location using corner pylons (separately available), empty cans or such. Running fast at straight section and slow down at curved section is a basic speed control technique useful when driving R/C car.

## Maintain

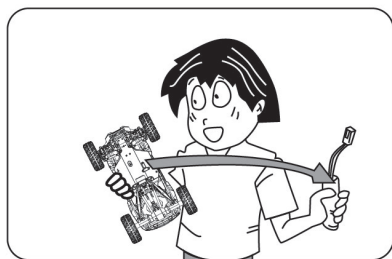

When the car is not in use, you should remove the battery from the car.



Completely remove sand, mud, dirt etc.

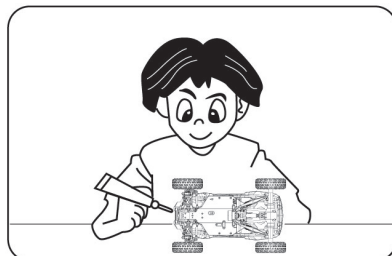

Metal outside should apply the rust prevention oil.

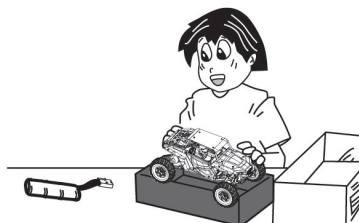

Store the car and batteries separately when not in use.



# Assembly Exploded Diagram

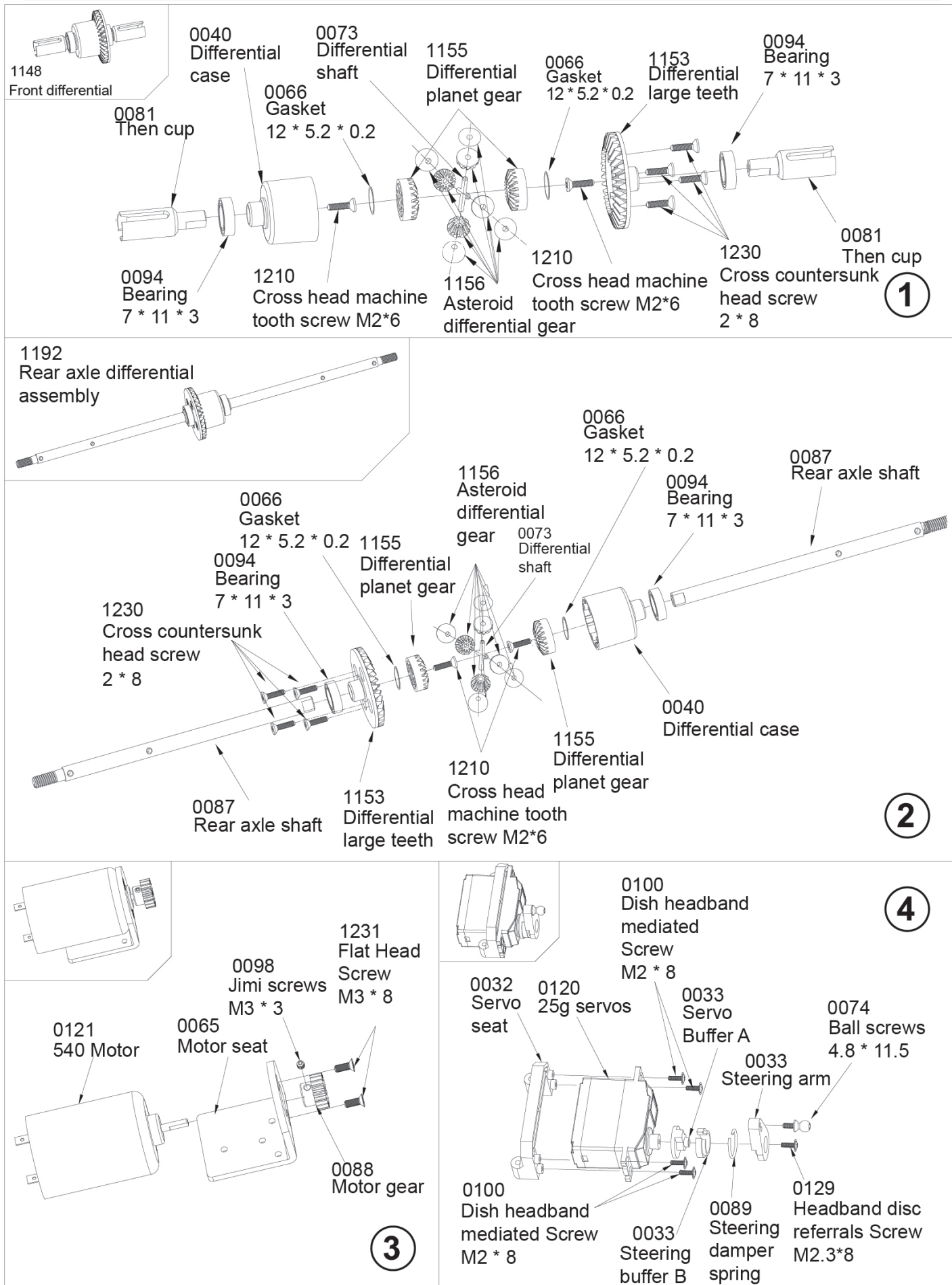

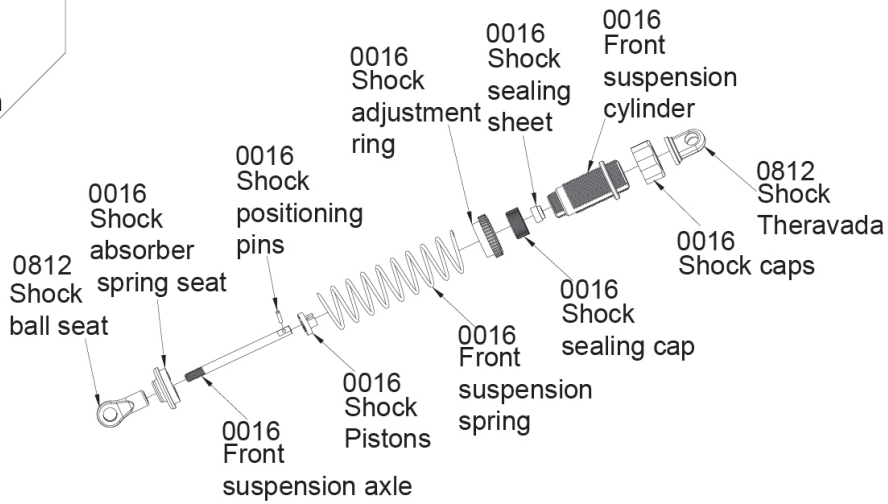

5

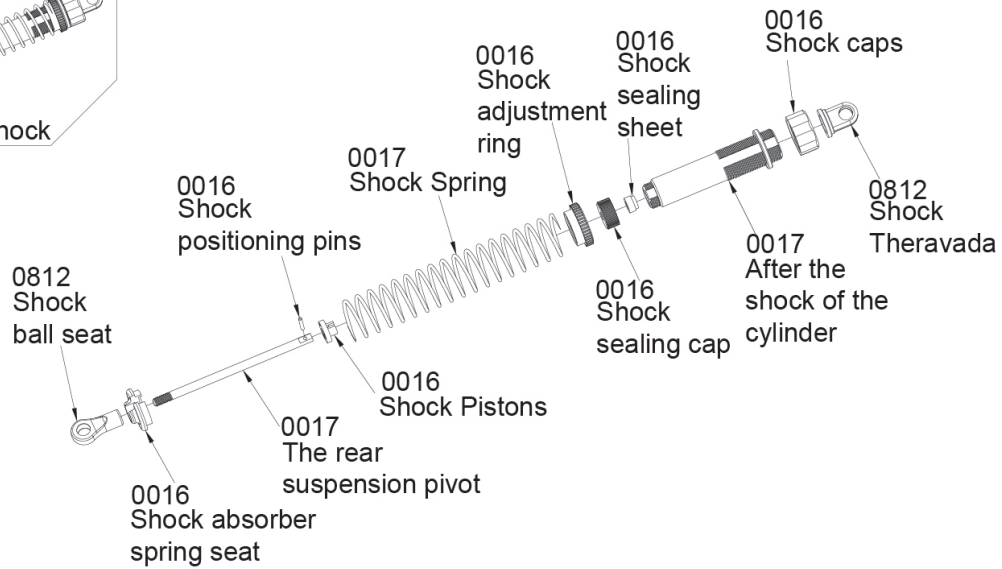

6

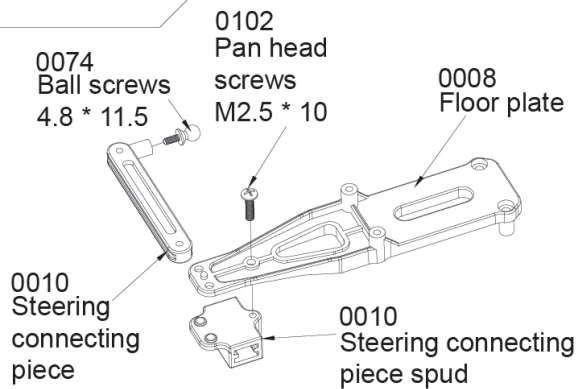
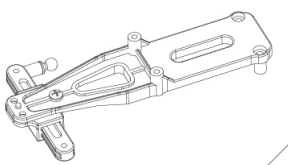

7

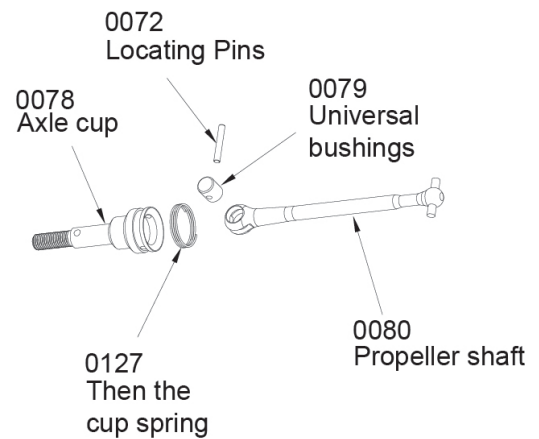

8

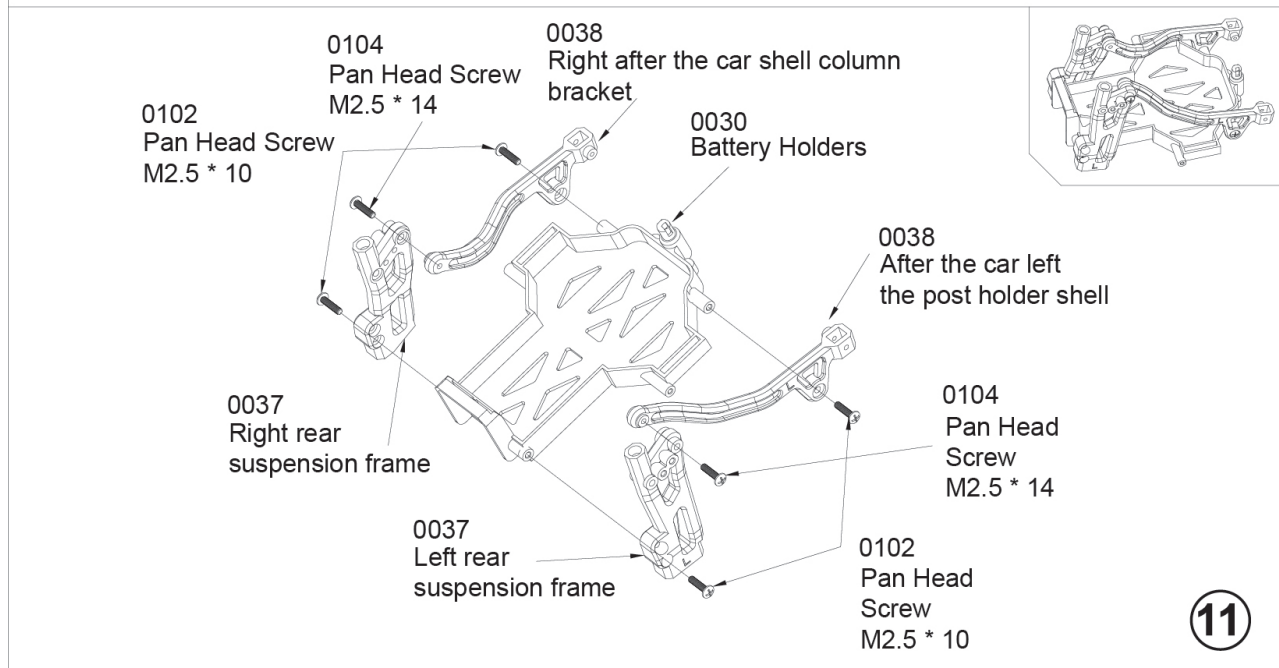
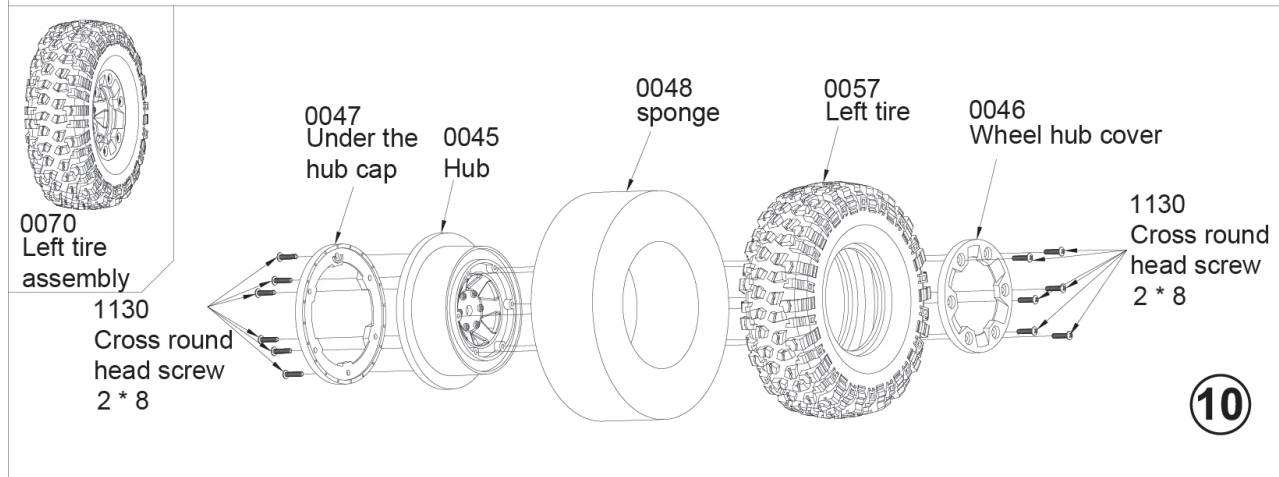
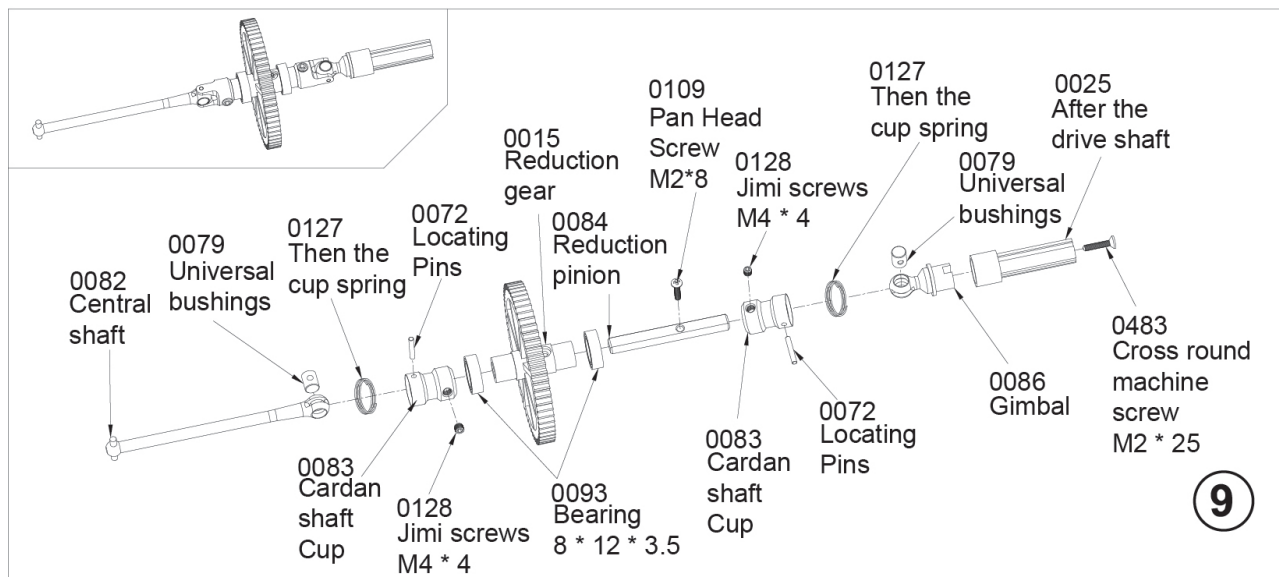

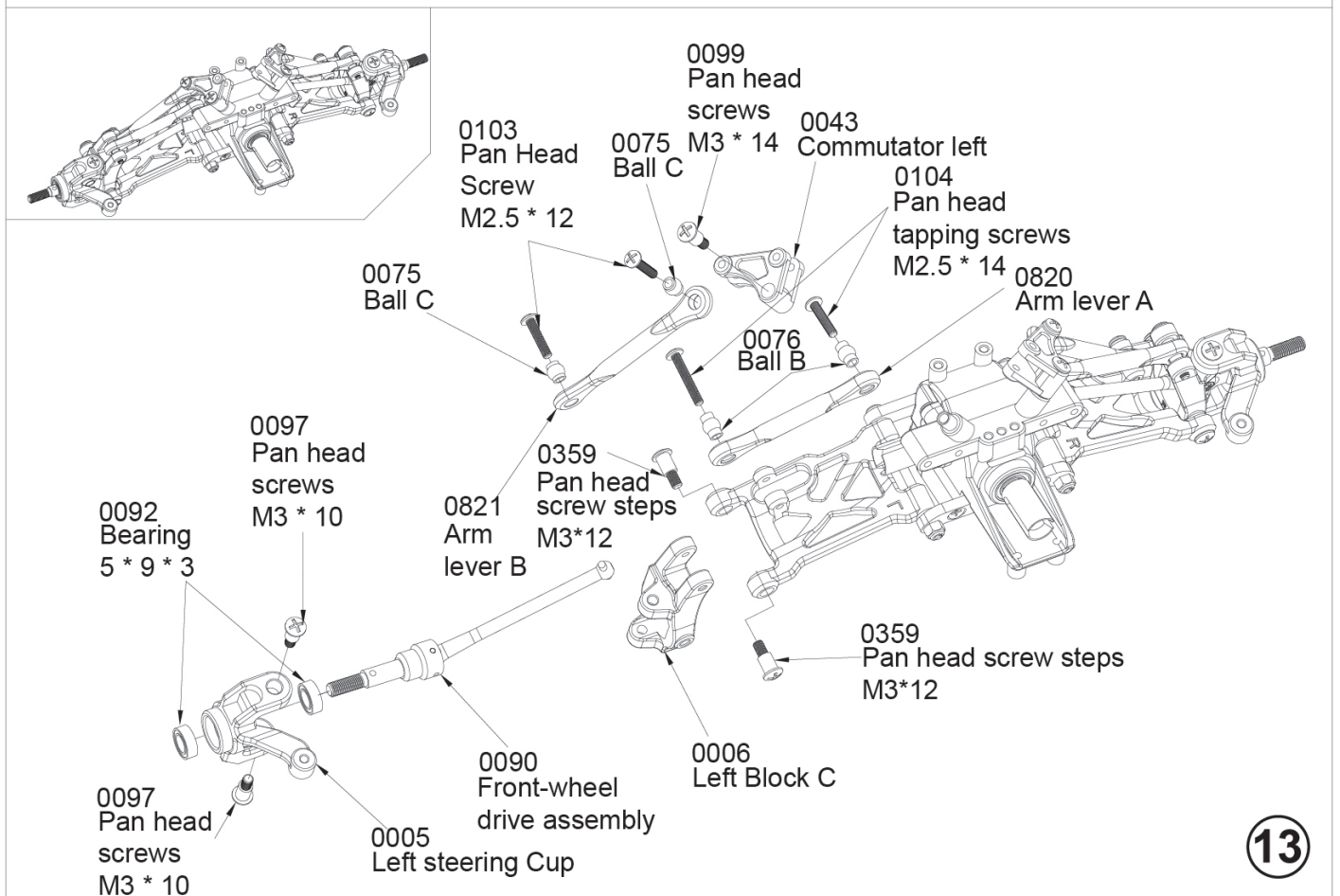
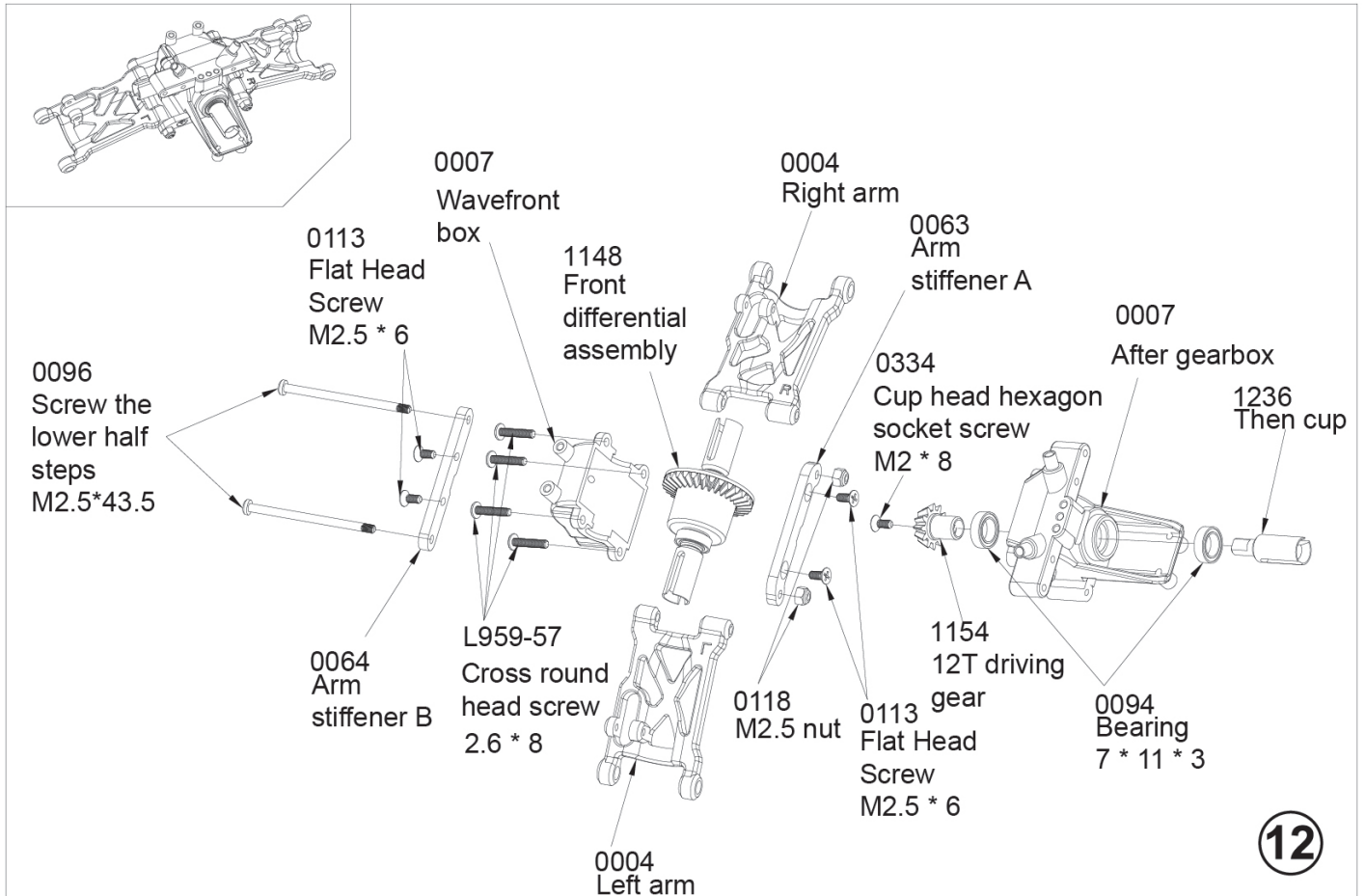



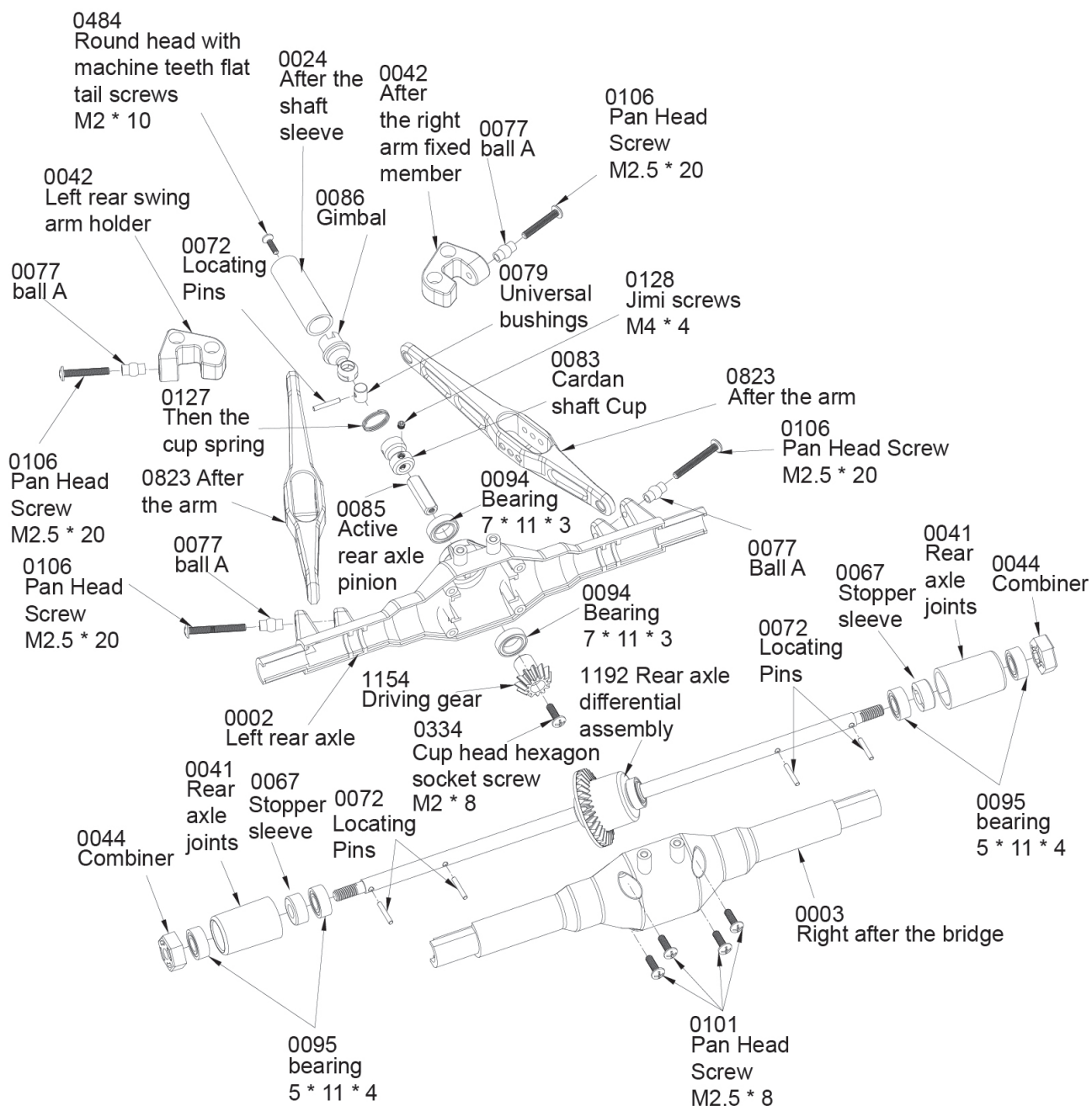
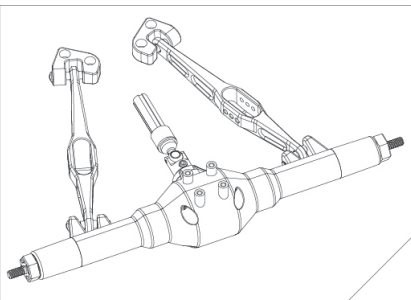



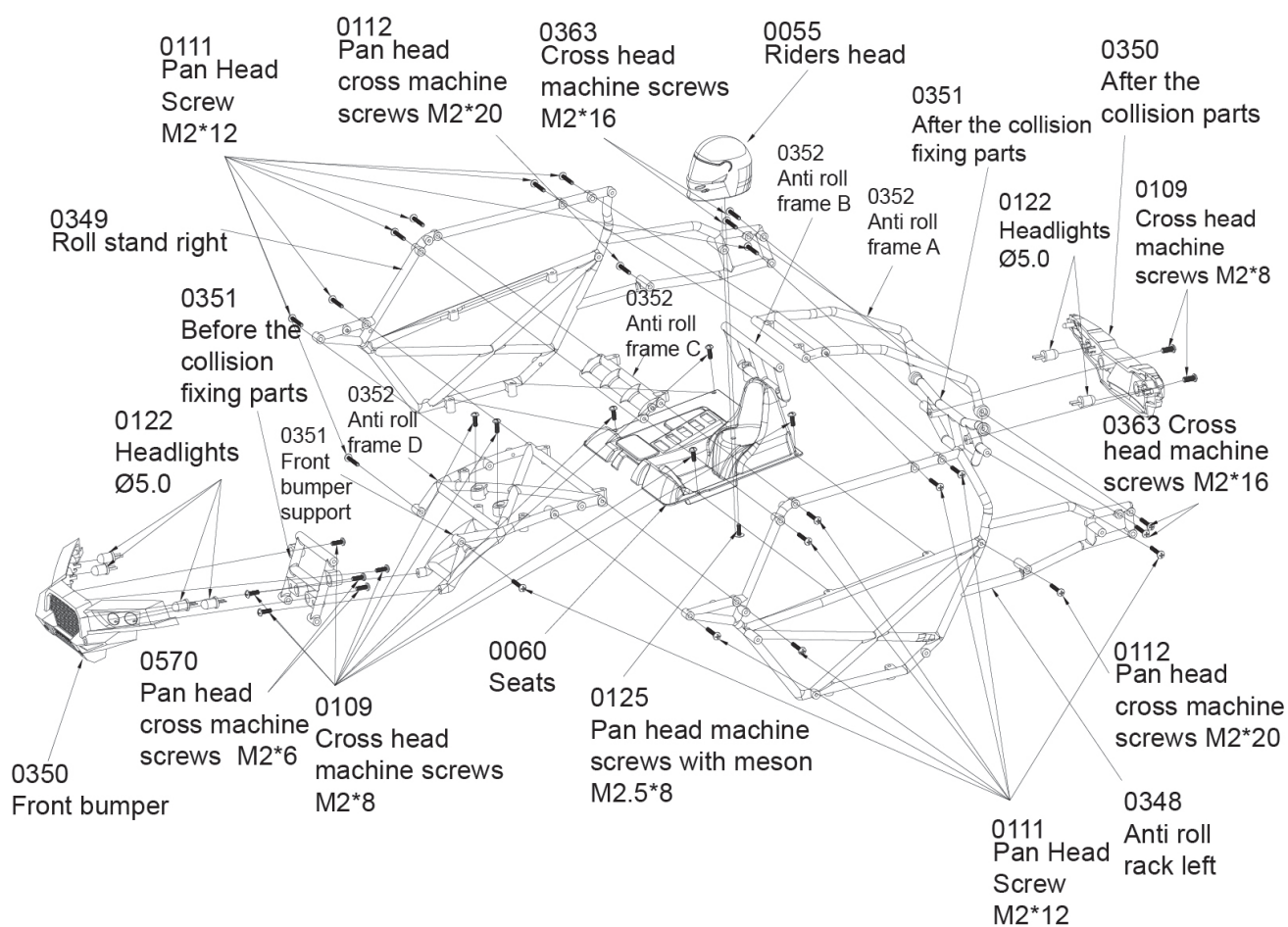
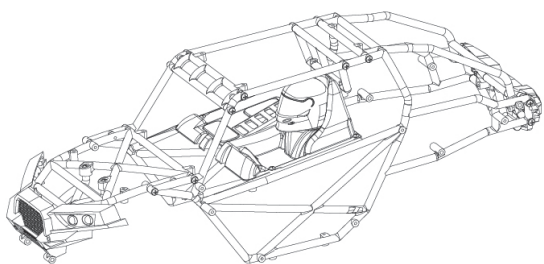

16

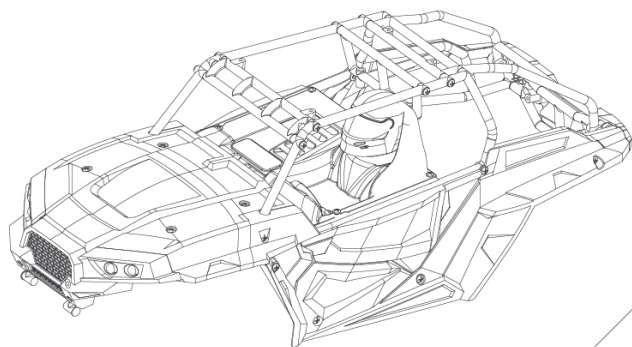

0109  
Pan Head  
Screw  
M2\*8

0353  
Right side  
of vehicle

0353 Headstock

0109  
Pan Head Screw  
M2\*8

0353  
Left side of vehicle

0109  
Pan Head  
Screw M2\*8

17

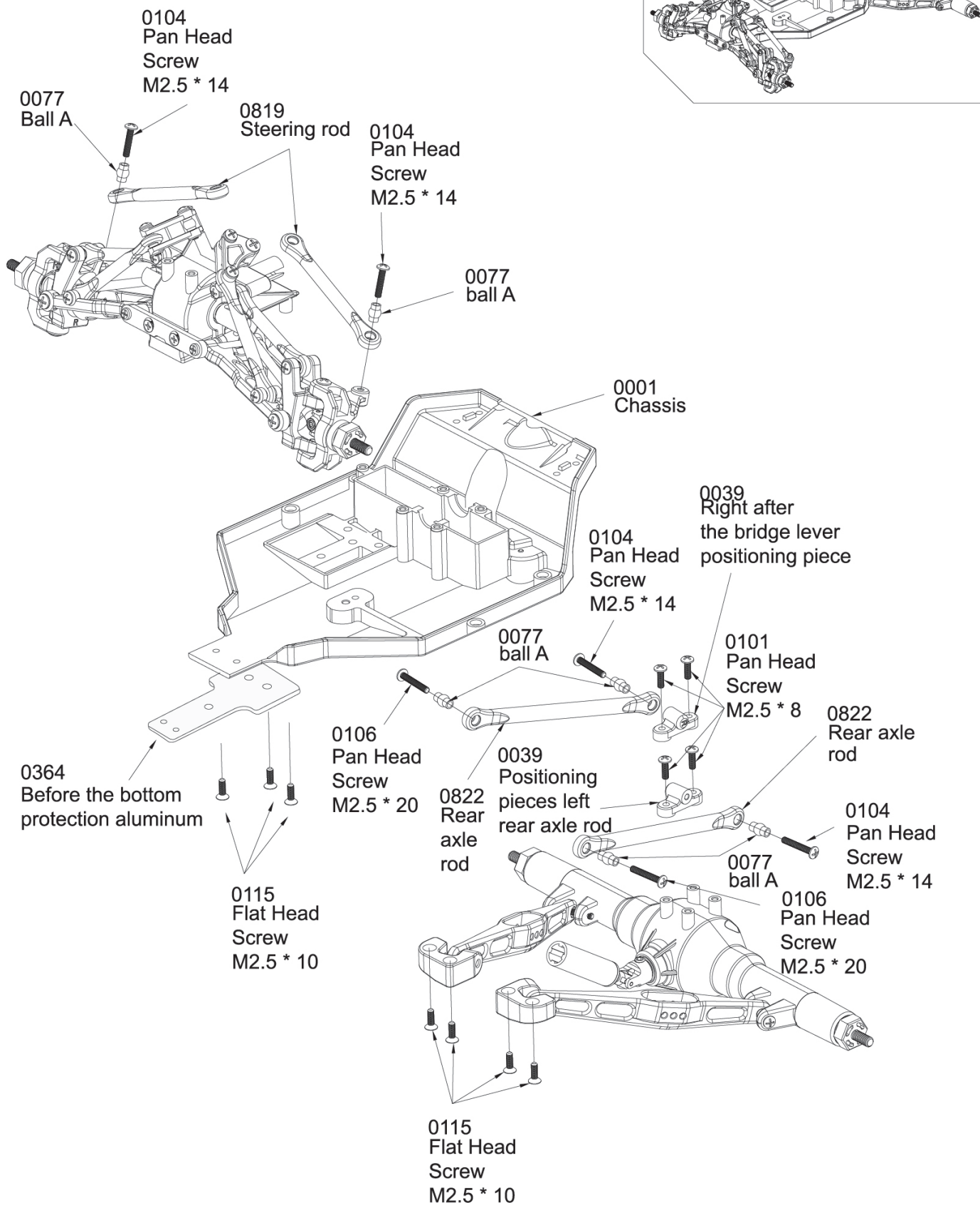

18

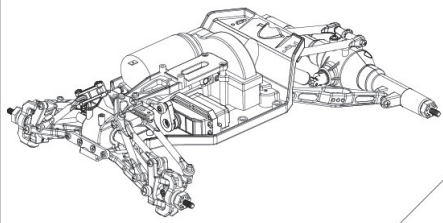

0105 Pan Head Screw M2.5 \* 16

0102 Pan Head Screw M2.5 \* 10

0009 Dust cover

0108 Pan Head Screw M3 \* 7

0818 Steering rod

0114 Flat Head Screw M2.5 \* 8

19

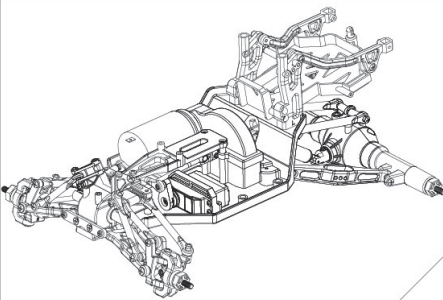

Battery holder assembly

0102 Pan Head Screw M2.5 \* 10



20

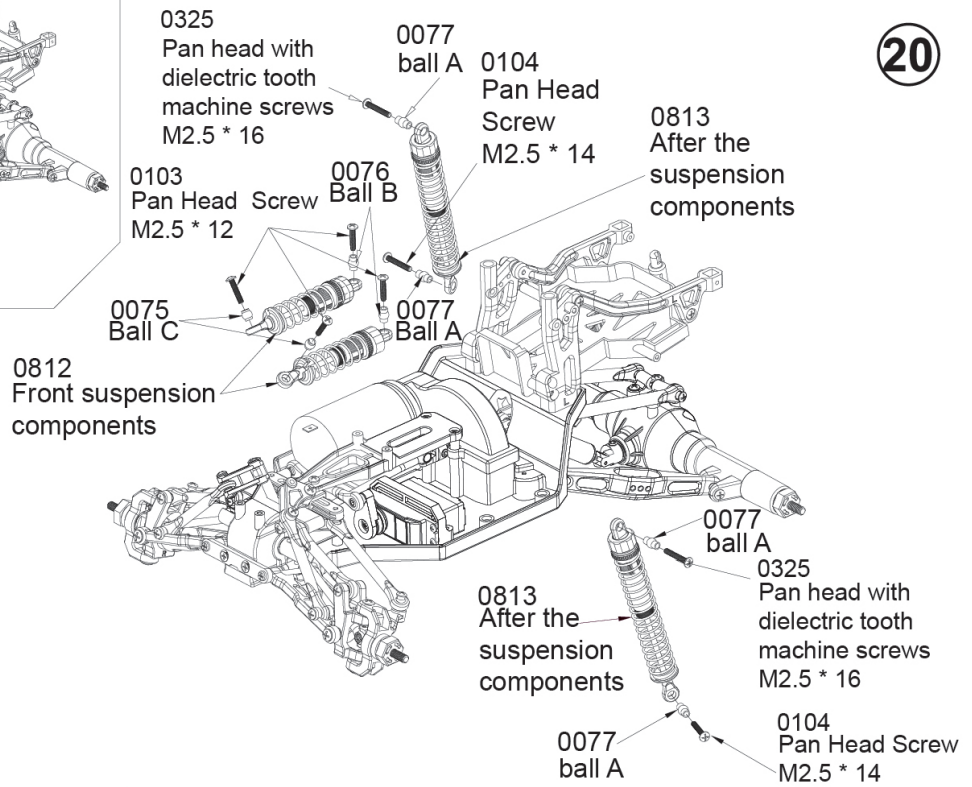
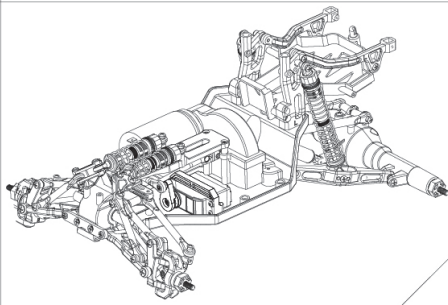

21

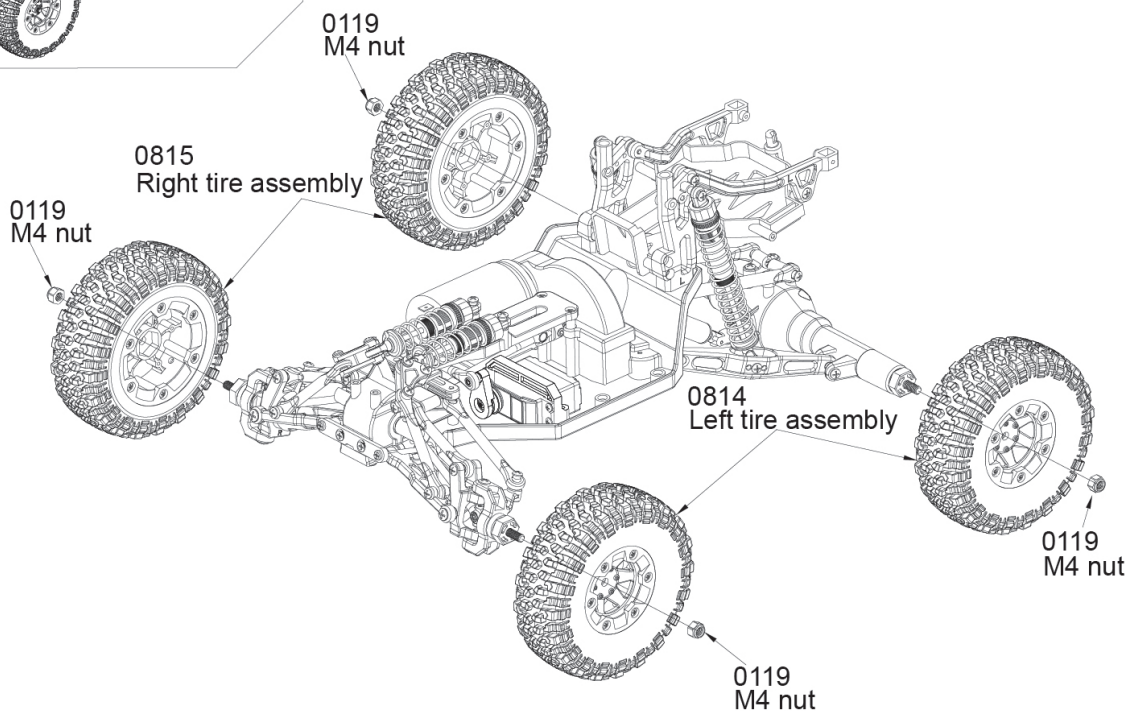
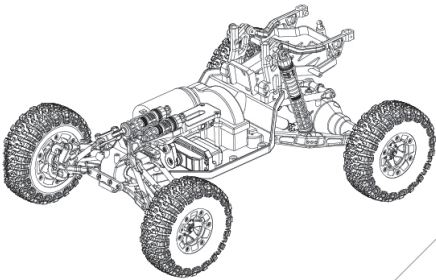



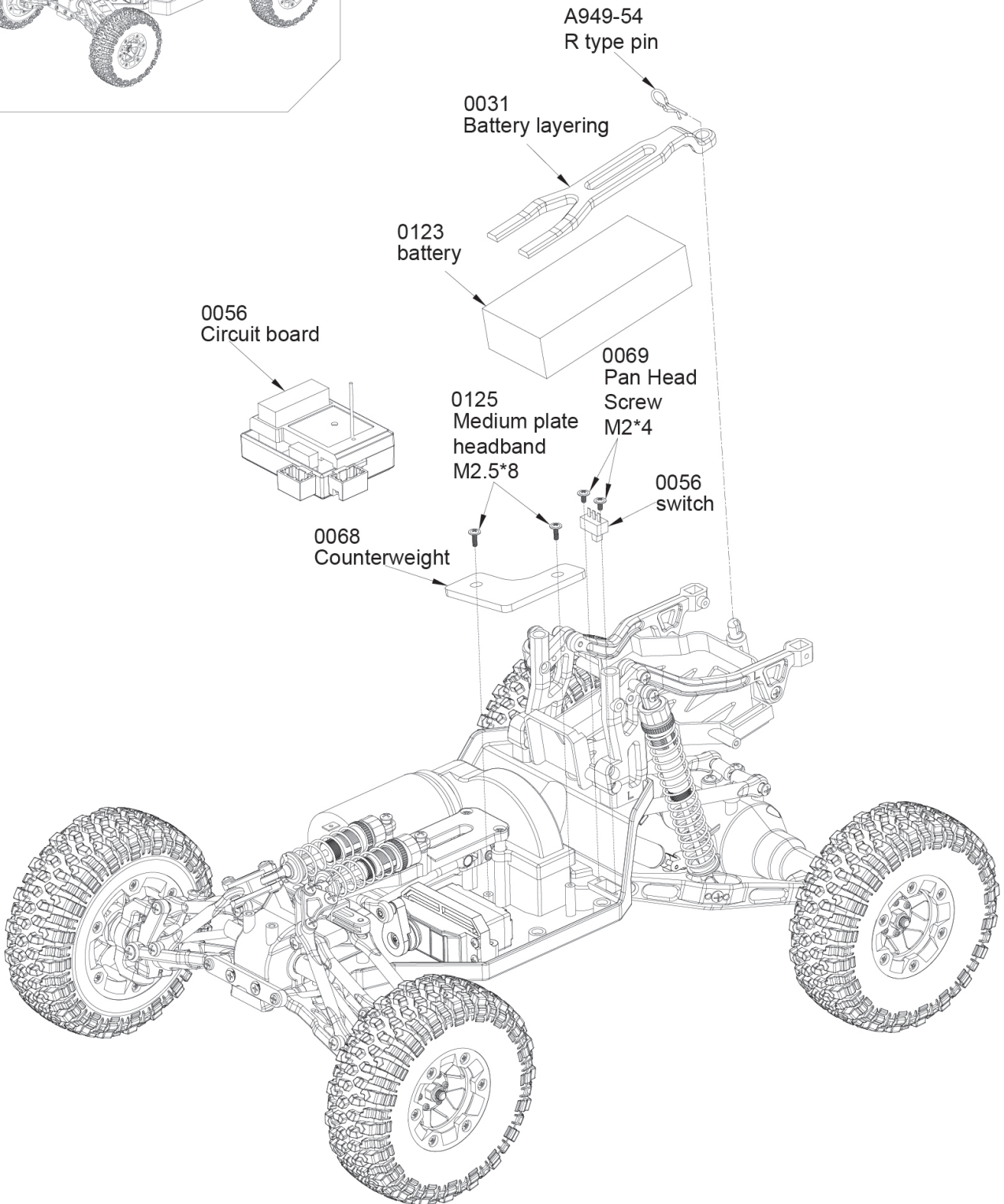
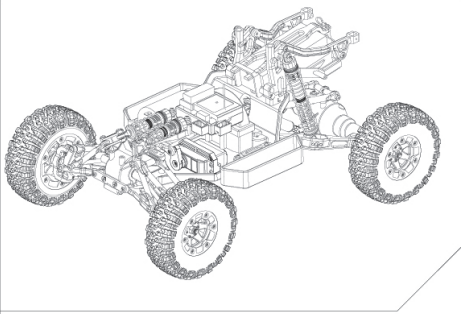

23

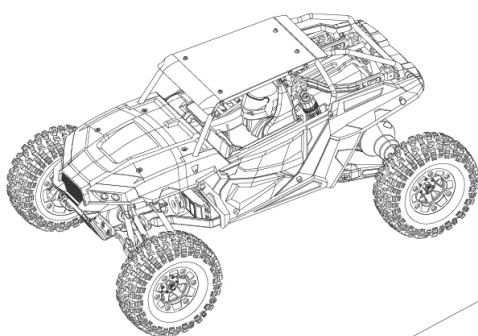

0109  
Pan head screw  
M2\*8

0353 The roof

0104  
Pan head  
cross machine  
screws  
M2.5\*14

0111  
Pan Head Screw  
M2\*12

0828  
Before climbing  
collision

0115  
Flat cross screw  
tooth machine  
M2.5\*10

0111  
Pan Head Screw M2\*12

## Sale parts view

0001

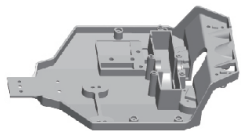

Chassis

0002



Left rear axle

0003



Right after the bridge

0004

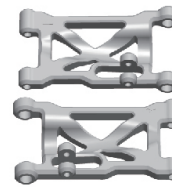

Left/Right arm

0005

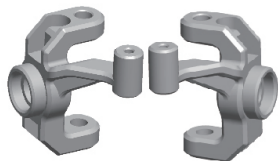

Left/Right  
steering Cup

0006



Left/Right Block C

0007

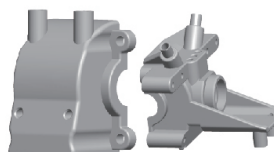

Wavefront box

0008



Floor board  
assembly

0009



Dust cover

0010

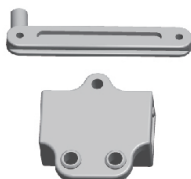

Steering  
connecting piece

1153



Differential  
planet teeth

1154



12T driving gear

1155



Differential  
planet gear

1156



Asterold  
differential gear

0015



Reduction gear

0812



Front suspension

0813

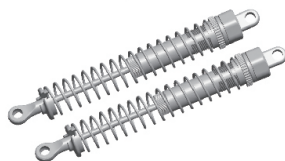

Rear Shock

0818

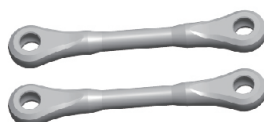

Steering rod

0819



Steering rod

0820



Arm leverA

# Sale parts view

0821



Arm lever B

0822



Rear axle rod

0823



After the arm

0024



After the shaft sleeve

0025



After the drive shaft

0030

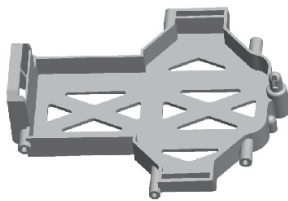

Battery Holders

0031



Battery layering

0032



Servo seat

0033

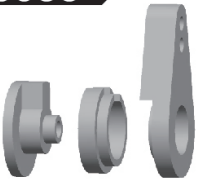

Steering arm

0037

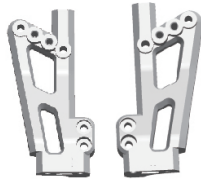

Left/Right rear suspension frame

0038



Left/Right after the car shell column bracket

0039



Left/Right after the bridge lever positioning piece

0040

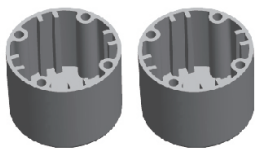

Differential case

0041

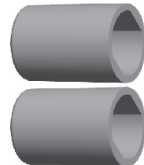

Rear axle joints

0042



Left/Right Rear swing arm holder

0043

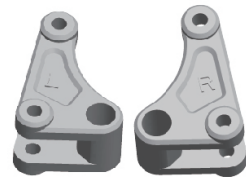

Left/Right Commutator

0044

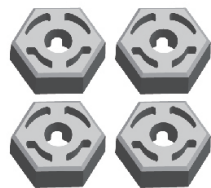

Combiner

0045



Hub

0046



Wheel hub cover

0047



Under the hub cap



# Sale parts view

0048



Sponge

0828

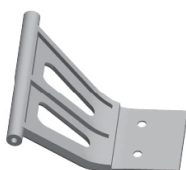

Climbing  
before crash

0055



Riders head

0056

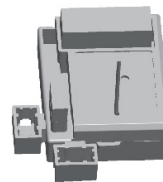

Circuit board

0057



Left tire

0058



Right Tire

0060



Seat

A949-54



R type pin

0063



A swing arm stiffener

0064



Arm strengthen  
slice B

0065



Motor seat

0066



Gasket  
12 \* 5.2 \* 0.2

0067



Stopper sleeve

0068

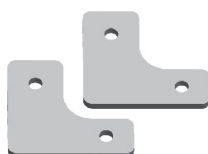

Counterweight

0069



M2 \* 4 screws

0814



Left tire assembly

0815



Right tire assembly

0072

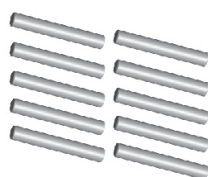

Locating Pins

0073



Differential shaft

0074



Ball screws 4.8\*11.5



# Sale parts view

0075



Ball C

0076



Ball B

0077

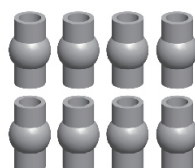

Ball A

0078

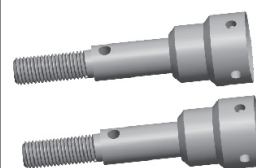

Axle cup

0079



Universal bushings

0080



Propeller shaft

0081

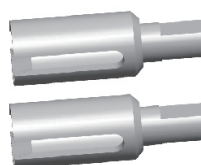

Then cup

0082



Central shaft

0083

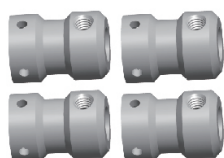

Cardan shaft Cup

0084



Reduction pinion

0085



Active rear axle pinion

0086



Gimbal

0087



Rear axle shaft

0088



Motor gear

0089



Steering damper spring

0090



Front-wheel drive shaft

1148

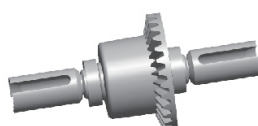

Front differential

0092

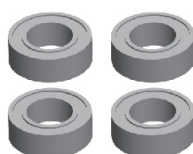

Bearing 5\*9\*3

0093



Bearing 8\*12\*3.5

0094



Bearing 7\*11\*3

# Sale parts view

0095

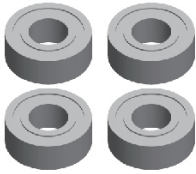

Bearing 5 \* 11 \* 4

1237



Screw the lower  
haft steps M2.5\*43.5

0097



Pan head screws  
M3\*10

0098

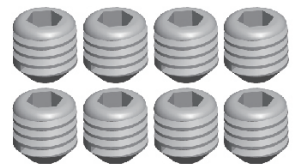

Jimi screws  
M3\*3

0099



Pan head screws  
M3\*14

0100



Dish headband  
mediated M2\*8

0101

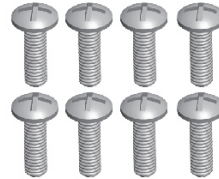

Pan Head Screw  
M2.5\*8

0102



Pan Head Screw  
M2.5\*10

0103



Pan Head Screw  
M2.5\*12

0104

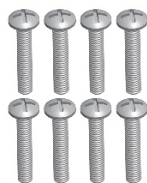

Pan Head Screw  
M2.5\*14

0105

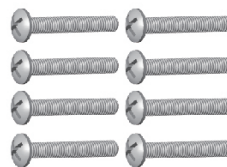

Pan Head Screw  
M2.5\*16

0106

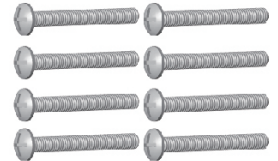

Pan Head Screw  
M2.5\*20

0108



Pan Head Screw  
M3\*7

0334



Cup head hexagon  
socket screw M2\*8

0111

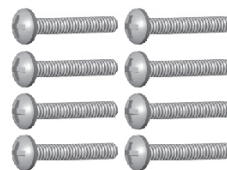

Pan HeadScrew  
M2\*12

0112

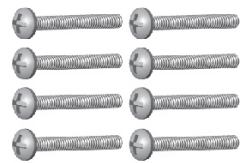

Pan Head Screw  
M2 \* 20

0113



Flat Head Screw  
M2.5\*6

0114

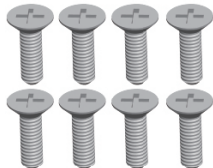

Flat Head Screw  
M2.5\*8

0115



Flat Head Screw  
M2.5\*10

1230

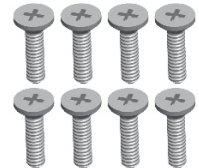

Cross countersunk  
head screw M2\*8

## Sale parts view

1231



Flat Head Screw  
M3\*8

0118

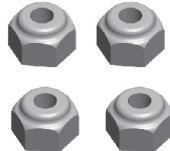

M2.5 nut

0119

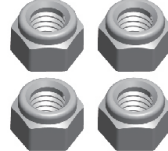

M4 nut

0120

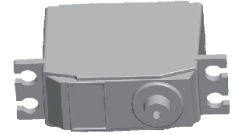

25g servos

0121

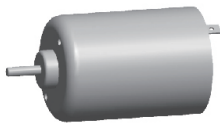

540 Motor

0122



Headlight

0123



Battery

1374



Charger

0125



Medium plate headband  
M2.5\*8

0127



Then the cup spring

0128



Jimi screws M4 \* 4

0129



Headband disc  
referrals Screw  
M2.3\*8

0364



Before the bottom  
protection aluminum

1192



After the differential  
component

0325



Pan head with dielectric  
tooth machine screws  
M2.5\*16

0776



V2 LCD version of the  
remote control

0348



Anti roll rack left

0349



Anti roll rack right

0350



Anti collision

0351

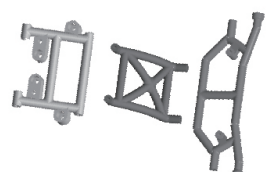

Anti collision  
fixing element



# Sale parts view

0352



Anti roll frame

0353

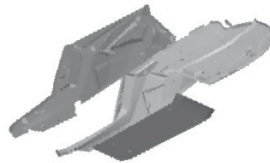

Car shell

0354



Frame set

0359



Pan head screw steps  
M3\*12

0483



Cross round machine  
screw M2\*25

1210



Round head cross  
screw M2\*6

0758



Headinght plate  
assembly

0759



Rear plate  
assembly

0476



Rear drive shaft  
assembly

0477



Rear drive sleeve  
assembly

0478



Central drive shaft  
assembly

0484



Round head with  
machine teeth flat  
tail screws M2\*10

0781



Cardan shaft cup  
assembly

0109



Cross head machine  
tooth screw M2\*8

0363



Cross head machine  
screws M2\*16

0762



The shaft sleeve

0763



The shaft

1130



Cross round head self  
tapping screw M2\*8

1193



Drive shaft assembly

L959-57



Cross round head  
screw 2.6\*8



## Sale parts view

1230



Cross countersunk  
head self tapping  
screw 2\*8

1236

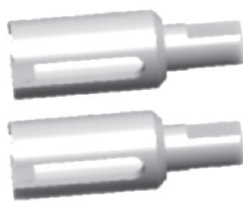

Differential cup

1241

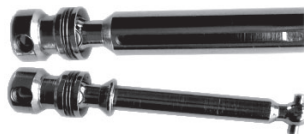

Metal drive shaft  
assembly